

Extractors for efficient carpet-deep cleaning.

Carpets in office buildings, hotels and schools are subject to heavy traffic every day which is why cleaning professionals prefer Kärcher carpet cleaning machines. These robust, powerful and versatile machines are designed for cleaning carpets deep into the pile and are ideal for interim use and removing stains from a variety of textiles. Ideal for cleaning vertical blinds, upholstery and car seats and with the appropriate accessories, they can also be used for cleaning tiles and windows.

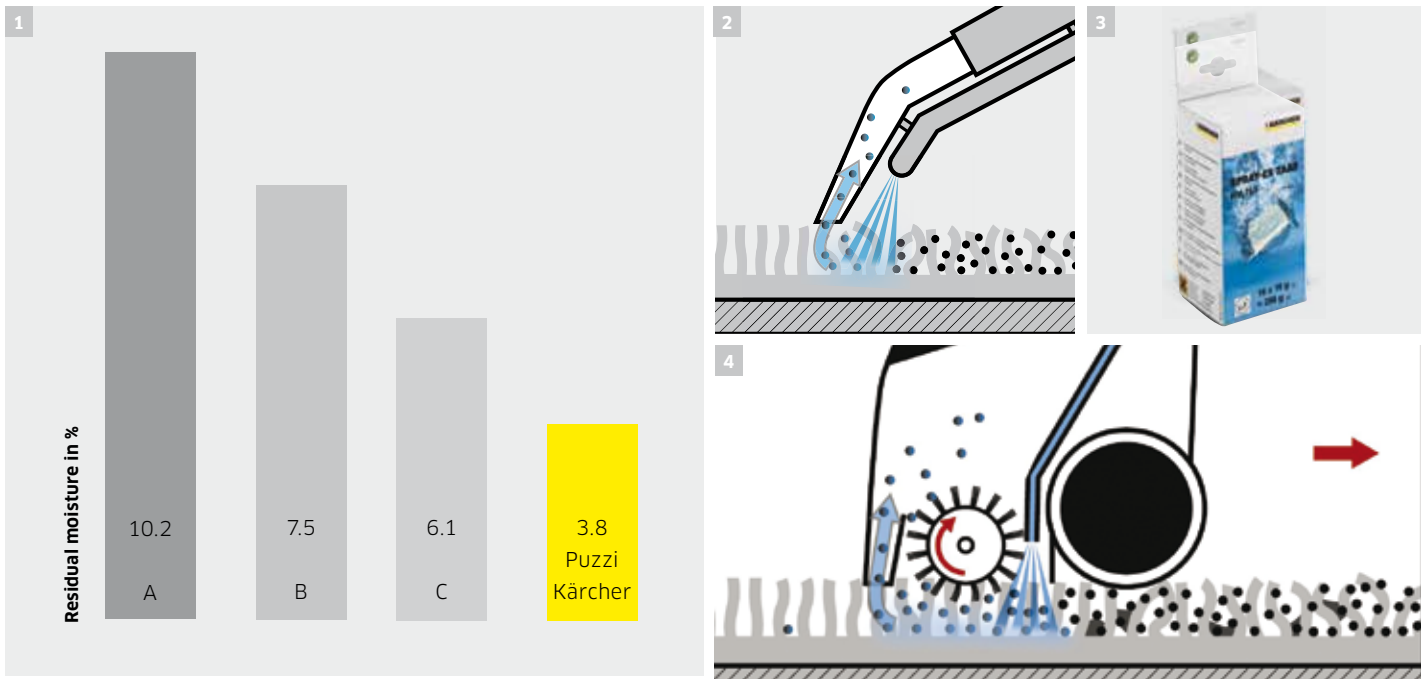



1 Quick-drying

- The powerful suction turbine of the Kärcher Puzzi leaves carpets virtually touch-dry in minutes. Carpets dry up to 63% faster than comparable products and can be walked on in a very short time.

2 Spray extraction method

- With the spray extraction method, the water and cleaning agent are sprayed deep into the carpet while simultaneously vacuuming the used solution back again. Soiling and dirt are removed in one single pass which helps carpets dry very quickly.

3 Kärcher cleaning agents

- Effective against dirt but still environmentally friendly. All cleaning agents are more than 92% biodegradable. They are highly efficient and help make your work easier, faster, and more comfortable. Kärcher cleaning agents optimize the cleaning result saving time and manpower.

4 Thorough cleaning

- Carpet cleaning machines with roller brush system support the cleaning action of the cleaning agent and raise the pile.

Puzzi 8/1 C



Handy and compact.

The handy, compact and powerful Puzzi 8/1 C spray extraction cleaner is ideal for small areas and interim cleaning with excellent cleaning results.



1 Lightweight

- The Puzzi 8/1 C is easy to transport, weighs only 19.8 lbs, making it ideal for interim cleaning, and leaves carpets touch-dry in minutes.
- Easy to fill and begin operation in seconds.

2 Compact design

- Perfect for cleaning upholstery and vehicle interiors.

3 Easy use

- Convenient on/off foot switch eliminates bending.
- Fold out hook keeps power cord neatly stowed on machine.
- CSA listed

Technical data and equipment

Puzzi 8/1 C

- Foldable cable hook
- Large foot-operated switches
- On-board storage for hand tool

Technical data

Max. area performance	129 - 194 ft ² /hr
Air flow rating	115 cfm (58 l / sec)
Spray rate	.26 gallon / min (1 l / min)
Spray pressure/back pressure	14.5 psi (1 bar)
Tank (fresh/dirty)	2 gallon / 1.8 gallon (8 l / 7 l)
Power rating (fan/pump)	1,100 W / 40 W
Vacuum motor	1.5 hp (1,100 W)
Waterlift rating	87" (216 mbar)
Moisture recovery rate	Up to 96%*
Noise	71 dBA
Weight	19.8 lbs (9 kg)
Dimensions (L x W x H)	20.8" x 13" x 17.3" (530 mm x 330 mm x 440 mm)

Equipment

Spray hose with integrated water feed	98.5"
Hand tool	■ n
Order No.	1.100-223.0

■ Included in delivery. * Varies depending on carpet fiber type or material being cleaned.

Standard Accessories

Product name	Order No.	Description
Hose	6.391-410.0	8' Hose, Complete with couplings
Hand Tool	4.130-116.0	4.33" Upholstery Hand Tool

Optional Accessories

Floor Wand	4.130-127.0	Floor Wand, 2-Part with Aluminum Tube
Floor Wand	4.130-394.0	Floor Wand, Quick-Action Coupling, Aluminum Tube and Metal Nozzle
Hard Surface Kit	4.762-220.0	Hard Surface Kit (attaches to 4.130-127.0 & 4.130-394.0 wands)
Window Cleaning Kit	2.638-778.0	Window Cleaning Kit with 6.5ft (2M) Hose, (requires 2.389-293.0 Coupler)
Venetian Blind Kit	4.130-083.0	Venetian Blind Kit (requires 6.389-293.0 Coupler)
Stair Cleaning Tool	4.130-128.0	Stair Cleaning Tool, 9"
Solution & vacuum hose	6.391-411.0	13' High Pressure Solution & vacuum hose
Hose	6.391-410.0	8' Hose, Complete with couplings
Surface Nozzle	4.130-117.0	Stone & Hard Surface Nozzle
Adaptor	4.762-219.0	Hard Surface Adaptor for Standard Hand Tool
Tablets	6.290-500.0	RM 760 Tablets, 200 Count
Tablets	6.290-828.0	RM 760 Tablets, 16 Count

Puzzi 100



Powerful & Efficient.

A powerful spray extraction unit designed for easy, efficient deep cleaning of carpets, upholstery and textile flooring. The Puzzi 100 is an exceptional all rounder, with added features which makes using the machine even quicker and easier.

1 Powerful

- With a powerful 14.5 psi spray rate, the water and detergent solution is applied to the area being cleaned and picked up immediately by the vacuum nozzle.
- Cleaned surfaces can be walked on almost right away as very little residual moisture remains. Carpets dry up to 63% faster than those cleaned with other comparable products.

Technical data and equipment

Puzzi 100

- Rubber cushioned pump / turbine module
- Detachable wastewater container
- Additional handle (adjustable) on the floor nozzle

Technical data

Max. area performance	215-270 ft ² /hr
Air flow rating	114 cfm (54 l / sec)
Spray rate	.26 gallon / min (1 l / min)
Spray pressure/back pressure	14.5 psi (1 bar)
Tank (fresh/dirty)	2.6 gallon / 2.3 gallon (10 l / 9 l)
Power rating (fan/pump)	1,250 W / 40 W
Vacuum motor	1.7 hp (1,250 W)
Waterlift rating	88" (220 mbar)
Weight	22.7 lbs (10.3 kg)
Dimensions (L x W x H)	26.2" x 12.6" x 17.1" (665 mm x 320 mm x 435 mm)

Equipment

Spray hose with integrated water feed	98.5"
Hand tool	■ n
Order No.	1.100-123.0

■ Included in delivery. * Varies depending on carpet fiber type or material being cleaned.

Standard Accessories

Product name	Order No.	Description
Hose	6.391-410.0	8' Hose, Complete with couplings
Hand Tool	4.130-127.0	Floor Wand, 2-Part with Aluminum Tube

Optional Accessories

Hard Surface Kit	4.762-220.0	Hard Surface Kit (attaches to 4.130-127.0 & 4.130-394.0 wands)
Floor Wand	4.130-394.0	Floor Wand, Quick-Action Coupling, Aluminum Tube and Metal Nozzle

Puzzi 200



Double the power. (available in 220V 50hz only)

The spray rate and pressure of the Puzzi 200 is double that of the Puzzi 100, giving you increased cleaning performance. The Puzzi 200 is also fitted with a defoaming tank, which when used with Kärcher anti-foaming chemical, stops the build up of foam in the dirty water tank. This is particularly helpful for cleaning areas that have previously been treated with chemical.



1 Diverse Applications

- Ideal for use in hotels, restaurants, shops and the automotive industry.

Technical data and equipment

Puzzi 200

- Foam dosage
- Storage compartment for RM tabs
- Socket for PW 30/1

Technical data

Max. area performance	323-484 ft ² /hr
Air flow rating	114 cfm (54 l / sec)
Spray rate	.52 gallon / min (2 l / min)
Spray pressure/back pressure	29 psi (2 bar)
Tank (fresh/dirty)	2.6 gallon / 2.3 gallon 10 l / 9 l)
Power rating (fan/pump)	1,250 W / 40 W
Vacuum motor	1.5 hp (1,100 W)
Waterlift rating	88" (220 mbar)
Weight	26.7 lbs (12.1 kg)
Dimensions (L x W x H)	26.2" x 12.6" x 17.1" (665 mm x 320 mm x 435 mm)

Equipment

Spray hose with integrated water feed	98.5"
Hand tool	■ n
Order No.	1.193-105.0

■ Included in delivery. * Varies depending on carpet fiber type or material being cleaned.

Puzzi 30/4



More flexibility for cleaning medium areas.

This mobile and very quiet machine is specifically designed for medium sized carpeted areas and represents a user-friendly and economic cleaning solution. It's new upright design offers comfortable ergonomic operation and improved productivity. The Puzzi 30/4 also has an integrated HEPA-level filter for optimal health protection. Accessories can be stored directly on the machine.

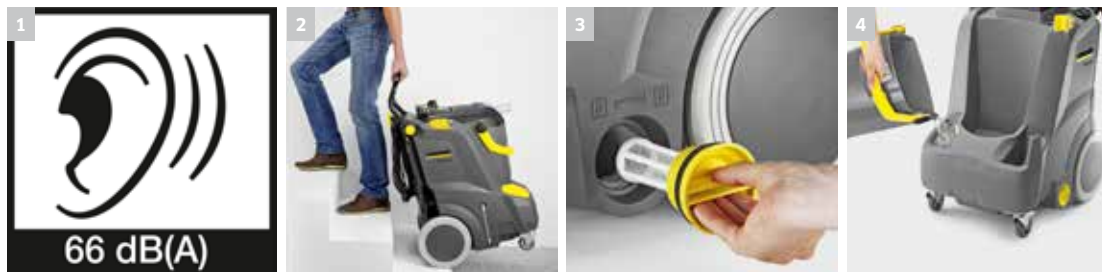

1 Extremely quiet

- Daytime cleaning and operation in noise-sensitive areas possible with the low noise level of 66 dBA.

2 Easy transport

- Big wheels enable simple and comfortable transport over thresholds and up and down stairs.
- Ergonomic operation and comfortable handling due to upright-concept.
- Easy transport – the machine can be moved lying on its back and with a full solution tank.

3 Easy use

- Easy removal of the fresh water filter.
- Solution level indicator.
- On-board storage for accessories.

4 Removable container

- Comfortable filling of solution tank.
- The container can be removed for emptying.

Technical data and equipment

Puzzi 30/4

- Removable waste water container
- Fresh water tank filling level display
- Horizontal transport possible with full fresh water tank

Technical data

Air flow rate	cfm	157 (4.5 m ³ /min)
Vacuum		102" H ₂ O (2591 mm)
Flow rate	gpm	0.8 (3 l/min)
Spray pressure	psi	58 (4 bar)
Tank, fresh water	gallons	8 (30 l)
Tank, dirt water	gallons	4 (15 l)
Electrical system		120 V, 10 amp
Operating noise level		66 dBA
Weight	lbs	61.6 (28 kg)
Dimensions (L x W x H)	inches	22.8" x 18.1" x 36.6" (58 cm x 46 cm x 93 cm)

Equipment

Suction hose (13 ft.)	■	n
Flexible floor nozzle (13.75")	■	
Home Base kit (adapter and cable hook)	■	
Handle with sight glass	■	
Floor nozzle	-	
Upholstery tool	-	
Crevice nozzle	-	
Hard surface adapter	-	
Order No.	1.101-126.0	

- Included in delivery.

Standard Accessories

Product name	Order No.	Description
Nozzle	4.130-011.0	Flexible Floor Nozzle (Assy)
Suction Hose	6.394-375.0	Suction Hose, 13 FT
Handle	4.130-000.0	Handle with Sight Glass
Adapter	5.035-488.0	Home Base Adapter

Optional Accessories

Nozzle	4.130-009.0	Floor Nozzle (Separate)
Upholstery Tool	4.130-001.0	Upholstery Tool
Nozzle	4.130-010.0	Crevice Nozzle
Adapter	4.762-017.0	Hard Surface Adapter

BRC 30/15 C



The perfect solution for larger areas.

Our carpet cleaning machines are ideal for efficient, fiber-deep cleaning of large areas; roller brushes support the cleaning action of the water and cleaning agent.



1 High cleaning performance

- Brush roller assists fiber-deep cleaning action.
- Floating brush roller for uniform contact pressure.
- Revives pile, giving carpets a fresh new look.

2 Compact dimensions

- Ideal for areas between 2150 ft² and 8600 ft².
- Easy storage.
- Easy to transport.

Technical data and equipment

BRC 30/15 CUL

- ETL listed
- For small to medium-sized areas
- Working direction, backwards
- Constant brush contact pressure

Technical data

Vacuum motor	1.5 hp, 3-stage
Air flow rate	120" (3050 mm)
Waterlift rate	100" waterlift
Solution pump	58 psi (3.5 bar)
Solution spray	1 quick-connect jet
Brush working width	10" (254 mm)
Working width, suction	12.5" (315 mm)
Tank (fresh/dirty)	4.6 gallon / 3.9 gallon (17.3 l / 14.71 l)
Noise level	73.7 dBA
Brush motor rating	80 W
Weight	75 lbs (34 kg)
Dimensions (L x W x H)	36.3" x 14" x 30" (920 mm x 360 mm x 750 mm)

Equipment

Working direction	backwards
Number of rollers	1

Order No.	1.008-058.0
------------------	--------------------

- Included in delivery.

Standard Accessories

Product name	Order No.	Description
Brush	8.621-604.0	Brush, Chevron, 10"
Brush	8.629-552.0	Brush, Extractor, Natural Bristles
Adapter	8.631-030.0	Assembly, Adapter (1/8" M X 1/4" FPT Nipple)

Optional Accessories

Handtool Kit	8.629-036.0	Handtool Kit with Bag
Adapter	8.600-075.0	Adapter for BRC 30/15 C

BRC 46/38 C



Designed for easy Maintenance

Designed for easy maintenance and servicing, to increase the life of your equipment investment.



1 Innovative design

- No-hose design makes filling and emptying easy.
- Easy adjustment of brush settings.
- Quick connect ports make attachment of tools quick and easy.

2 Superior performance

- Designed for easy maintenance and servicing.
- Easily combine optional accessories for spot, stair and furniture cleaning.

Technical data and equipment

BRC 46/38 C

- ETL listed
- No-hose design makes it easy to fill and empty
- Easily adjusted brush settings
- Quick connect ports for easily attached tools

Technical data

Vacuum motor	3 stage, bypass, 1.5 hp
Air flow rate	100 cfm
Waterlift rate	117" waterlift (2972 mm)
Solution pump	100 psi (6.4 bar)
Solution spray	2 quick-connect jets
Brush working width	18" (457 mm)
Working width, suction	21" (530 mm)
Tank (fresh/dirty)	10 gallon / 10 gallon (37 l / 37 l)
Noise level	75 dBA
Brush motor rating	250 W (1/3 hp)
Weight	94 lbs (42.6 kg)
Dimensions (L x W x H)	33" x 21" x 44" (840 mm x 530 mm x 1120 mm)

Equipment

Working direction	backwards
Number of rollers	1
Order No.	1.008-054.0

- Included in delivery.

Standard Accessories

Product name	Order No.	Description
Jet	8.600-458.0	Jet, Mini PROMAX 9504
Sp Brush,	8.600-115.0	Sp Brush, 18"

Optional Accessories

Handtool Kit	8.600-001.0	Handtool Kit with Bag
Squeegee assembly	8.602-852.0	Squeegee assembly 18"
Replacement blade	8.622-959.0	Replacement blade, 18" squeegee
MicroFilter™ Kit	9.840-551.0	Air Quality MicroFilter™ Kit (Includes 2 filters and stainless steel bracket)
MicroFilter™ Refill	8.623-611.0	One Air Quality MicroFilter™ Refill

BRC 46/76 W



Deep, restorative extraction.

The most value per gallon capacity in the industry. Performance breakthroughs and ergonomics create a carpet extractor that maximizes operator productivity. Exceptional maneuverability and compact design makes it easy to operate in small areas.

1 Designed for productivity

- Self-propelled design.
- Low profile for exceptional maneuverability.
- 20 gallon capacity

2 Superior performance

- Designed for easy maintenance and servicing.
- Easily combine optional accessories for spot, stair and furniture cleaning.

Technical data and equipment

BRC 46/76 W

- ETL listed
- Self-propelled design for operator productivity
- Low profile compact design for exceptional maneuverability
- 20 gallon capacity

Technical data

Vacuum motor	3 stage, bypass, 1.5 hp
Air flow rate	100 cfm
Waterlift rate	120" waterlift
Solution pump	100 psi (6.4 bar)
Solution spray	2 quick-connect jets
Brush working width	18" (460 mm)
Working width, suction	22" (560 mm)
Tank (fresh/dirty)	10 gallon / 10 gallon (37 l / 37 l)
Noise level	75 dBA
Brush motor rating	250 W
Weight	120 lbs (55 kg)
Dimensions (L x W x H)	51" x 22" x 44" (1300 mm x 560 mm x 1110 mm)

Equipment

Working direction	Forwards
Number of rollers	1
Order No.	1.008-650.0

- Included in delivery.

Accessories

Standard Accessories

Product name	Order No.	Description
Brush	8.600-112.0	Brush, 18 L X 4.5 OD
Jet	8.600-458.0	Jet, Mini PROMAX 9504

Optional Accessories

Tool Adapter	8.608-908.0	BRC 46/76 Vacuum Accessory Tool Adapter
Carrying Bag	8.600-175.0	Nylon Mesh Hose Carrying Bag
Adapter	8.626-069.0	Fill Hose with Faucet Adapter
Heating System Booster	8.604-105.0	Pro Heater™ 115V Heating System Booster
hose assembly	8.626-077.0	16 ft high temperature vac/solution hose assembly for use with Pro Heater™
Power Sprayer	8.604-106.0	115V ProSpray™ Power Sprayer (For applying Traffic Lane Cleaner, soil retardant, etc.)
Solution Spotter Adapter	8.600-075.0	Solution Spotter Adapter (1/4" QD Plug X 1/8" FPT Female QD; 13" Long)
Handtool, Spotter Kit	8.621-879.0	Handtool, Spotter Kit with Vacuum and Solution Hoses, 1/8" QD Coupler
Handtool, Spotter Kit	8.629-036.0	Handtool, Spotter Kit with Bag (Includes 8.621-879.0 above)
Deluxe Hand Tool Kit	8.600-001.0	Deluxe Hand Tool Kit (Includes 12' Hose & Carrying Bag) Requires 8.600-075.0 adapter!
Handtool	8.600-002.0	Handtool - 3" Vacuum Head, 250 PSI
Kurve™ Carpet Extraction Wand	8.634-234.0	Kurve™ Carpet Extraction Wand, 13"-Wide, 500 PSI, Aluminum Construction with Ergonomic Design
Deluxe Professional Wand	8.600-060.0	Deluxe Professional Wand - 500 PSI, 63"-long with S-Bend for Under Desk and Furniture Cleaning Ships with 100 PSI Nozzles; See Wand Nozzles Below for Other Pressures
Standard Wand	8.600-061.0	Standard Wand - 100 PSI, 12"-Wide Stainless Steel, Heavy-Duty Wand for Use on Any Carpet
Spotting Wand	8.600-005.0	Spotting Wand - 100 PSI Lightweight Stainless Steel Spotting Wand, 56.5" in length
Hard Floor Flip/Flop Tool	9.840-628.0	Spotting Wand Kit (Includes Spotting Wand, 12' Vacuum & Solution Hose and carrying case)
Hard Floor Flip/Flop Tool	8.604-148.0	Hard Floor Flip/Flop Tool - Converts BRC to Hard Surface Cleaning Tool. Consists of 15" X 1.5" Scrub brush on one side and Wet Squeegee Pick-up on the Other
Fastaction Spray Wand	8.604-119.0	Fastaction Spray Wand with 25' Solution Hose
Extractor Spotting Wand	8.604-118.0	Extractor Spotting Wand - 18" Spray Wand with 4' Solution Hose for Pre-Spraying while Extracting
Tee-Jet	8.624-157.0	Tee-Jet, Stainless Steel, 11002 (100 PSI Pumps)
Tee-Jet	8.620-176.0	Tee-Jet, Stainless Steel, 110015 (200 PSI Pumps)
Tee-Jet	8.620-167.0	Tee-Jet, Stainless Steel, 9501 (500 PSI Pumps)
Hose Assembly	8.600-414.0	Hose Assembly, 12', 250 PSI
Hose Assembly	8.600-415.0	Hose Assembly, 16', 250 PSI
Hose Assembly	8.628-416.0	Hose Assembly, 25', 250 PSI

Puzzi 50/35 C, Puzzi 50/14 E, Puzzi 64/35 E



Productive & Portable

Puzzi 13 and 17 gallon portable extractors are powerful and versatile. Available in hot and cold water models and adjustable to 1-200 psi and 1-500 psi.



1 Easily maneuverable

- Large transport wheels
- Compact size
- Handle with upper rear casters assist in loading and unloading

2 Innovative design

- On-board carrying system provides storage for your wand, cord, bucket and a quart of pre-spray
- Convenient easy access control panel

Technical data and equipment

	Puzzi 50/35 C	Puzzi 50/14 E	Puzzi 64/35 E
	<ul style="list-style-type: none"> ■ 13 gallon ■ 500 psi ■ ETL listed 	<ul style="list-style-type: none"> ■ 13 gallon ■ 200 psi ■ 1850 W heater 	<ul style="list-style-type: none"> ■ 17 gallon ■ 500 psi ■ 1850 W heater
Technical data			
Vacuum motor	One, three stage	Two, three stage	Two, three stage
Water lift	107" (2718 mm)	74" (1180 mm)	74" (1180 mm)
Air flow	73 cfm (2.06 m3/min)	111 cfm (3.14 m3/min)	111 cfm (3.14 m3/min)
Solution pump	500 psi	200 psi	500 psi
Heater		1850 W	1850 W
Tank (fresh/dirty)	13 gallon / 11 gallon (49.2 l / 41.6 l)	13 gallon / 11 gallon (49.2 l / 41.6 l)	17 gallon / 14 gallon (64.3 l / 53 l)
Electrical system	120 v, 15 amp	2 x 120 v, 15 amp	2 x 120 v, 15 amp
Power cable	1 cord	2 cords	2 cords
Wheels	2 x 4" (102 mm) 2 x 12" (305 mm) 2 x 3" (76 mm)	2 x 4" (102 mm) 2 x 12" (305 mm) 2 x 3" (76 mm)	2 x 4" (102 mm) 2 x 12" (305 mm) 2 x 3" (76 mm)
Weight	115 lbs (52.2 kg)	134 lbs (60.8 kg)	139 lbs (63 kg)
Dimensions (L x W x H)	30.5" x 22" x 43.25" (775 mm x 559 mm x 1098 mm)	30.5" x 22" x 43.25" (775 mm x 559 mm x 1098 mm)	32.5" x 22.5" x 43.25" (825.5 mm x 571.5 mm x 1098 mm)
Equipment			
Hose	<input type="checkbox"/>	<input type="checkbox"/>	<input type="checkbox"/>
Wand	<input type="checkbox"/>	<input type="checkbox"/>	<input type="checkbox"/>
Pressure gauge	■ n	■ n	■ n
Heater	-	■ n	■ n
Order No.	1.006-672.0	1.006-673.0	1.006-674.0

■ Included in delivery. □ Accessories available.

Optional Accessories

Product name	Order No.	Description
Kurve™ Deluxe Carpet Extraction Wand	8.634-234.0	Kurve™ Deluxe Carpet Extraction Wand, 13", 500 PSI
Hose Rack	8.632-885.0	Hose Rack
Complete Hose and Wand Kit	9.840-637.0	Complete Hose and Wand Kit (500 PSI Pro Wand, 25' Hose Set and Bag)
Deluxe Professional Wand	8.600-060.0	Deluxe Professional Wand * & 500 PSI High Temperature Hose
Vacuum Hose Set	8.626-074.0	16.5', 500 PSI Vacuum Hose Set
Vacuum Hose Set	8.624-189.0	25', 500 PSI Vacuum Hose Set
Auto detail kit	8.628-466.0	Auto detail kit with 25' vacuum hose (includes heavy-duty Auto Detail Tool, Crevice Tool with Detergent Application and Carry bag)
Deluxe Wand Nozzles,	8.624-157.0	Deluxe Wand Nozzles, Tee-Jet, Stainless Steel, 11002 (100 PSI pumps)
Deluxe Wand Nozzles,	8.620-176.0	Deluxe Wand Nozzles, Tee-Jet, Stainless Steel, 110015 (200 PSI pumps)
Deluxe Wand Nozzles,	8.620-167.0	Deluxe Wand Nozzles, Tee-Jet, Stainless Steel, 9501 (500 PSI pumps)

DE 4002



Hygienically clean without the use of chemicals.

Time is money - particularly in commercial cleaning. The DE 4002 equipment an ingenious filling system and convenience, making it ideal for commercial use.

Technical data and equipment

DE 4002

- Optional transport cart
- Short heating-up time
- Twin tank system with transfer pump for continuous use
- Filter funnel
- CSA listed

Technical data

Voltage	110 V
Steam temp/pressure	248° (3.2 bar)
Tank capacity	.63 gallon (2.4 l)
Cable length	24.5" (7.5 m)
Weight without accessories	17 lbs (7.5 kg)
Dimensions (L x W x H)	18" x 12" x 10.4" (456 mm x 305 mm x 265 mm)

Equipment

Steam suction hose with handle	■	n
Steam tubes 2x	■	n
Floor tool	■	n
Hand tool	■	n
Round brush, black	■	n
Upholstery tool with brush	■	n

Order No.	1.092-804.0
------------------	--------------------

- Included in delivery.

Standard Accessories

Product name	Order No.	Description
Steam Hose	4.321-114.0	Steam Hose
Extension Tube	4.127-023.0	Extension Tube
Floor Tool	2.884-278.0	Floor Tool, 12.4"
Hand Tool	4.130-144.0	Hand Tool
Cloth Set	6.960-019.0	Cloth Set w/ 2 large floor cloths & 3 covers for hand tool
Power Nozzle	2.884-282.0	Power Nozzle, DE 4002
Nozzle	2.884-281.0	Point Jet Nozzle

Optional Accessories

Window Nozzle	4.130-115.0	Window Nozzle
Brushes	6.962-139.0	Brushes 5 X Per Pack
Wallpaper Stripper	2.863-062.0	Wallpaper Stripper
Round Brush Set	2.863-077.0	Round Brush Set, 2X Red, 1X Black
Round Brass Brush Set	2.863-075.0	Round Brass Brush Set, 3 Nozzles
Microfiber Cloth Set	2.863-171.0	Steam+Clean Microfiber Cloth Set for Bathrooms (Includes 4 different clothes)
Microfiber Cloth Set	2.863-172.0	Steam+Clean Microfiber Cloth Set for Kitchens (Includes 4 different clothes)
Microfiber Cloth Set	2.863-173.0	Steam+Clean Microfiber Velour Floor Cloth Set (Includes 2 cloths)
Microfiber Cloth Set	2.863-174.0	Steam+Clean Microfiber Velour Cloth Covers for the Hand Tool (Includes 2 cloths)
Terry Cloth Towels	6.369-481.0	Extra-Wide, Hard Wearing, Terry Cloth Towels (set of 5)
Cart	6.962-239.0	Two Wheel Transport Cart

AB 84 CUL



Dry within minutes.

The powerful AB 84 air blower moves up to 3,000 cfm of air cutting drying times by up to 50%! The ideal solution for use in the building trade and for water damaged areas.



1 Built to last

- Wheels and push handle make this air blower easy to transport.
- Sturdy, four-point motor mount.
- Three standing positions.

2 Shorter drying times

- The AB 84 air blower shortens the drying time of spray-extracted or shampooed carpets by up to 50%.
- Built in carpet clip for use with flood restoration.
- For use with everything from emergency air removal from buildings to inflatable play grounds.

Technical data and equipment

AB 84 CUL

- 3-speed fan
- On-board cable storage
- Chassis with folding handle
- ETL listed

Technical data

Air flow rate (levels 1/2/3)	56 m ³ /min / 70 m ³ /min / 84 m ³ /min
Fan speed (levels 1/2/3)	1050 rpm / 1350 rpm / 1600 rpm
Cable length	25" (7.62 m)
Max. intake	700 W
Weight	39 lbs (17.6 kg)
Dimensions (L x W x H)	22.8" x 16" x 10.4" (580 mm x 410 mm x 264 mm)

Equipment

Sturdy plastic housing	■	n
Chassis with wheels	■	n
Ergonomic carrying handle	■	n
Folding Handle	■	n
On-board cable storage	■	n
Carpet clip	■	n

Order No.	1.004-053.0
------------------	--------------------

■ Included in delivery.